

ELECTRICAL SPECIFICATIONS

Nominal Capacity	33Ah
Nominal Voltage	12.8V
Discharge Energy	422.4Wh
Max. Charge Current	33A
Standard Cont. Discharge Current @25°C	6.6A
Max. Cont. Discharge Current @25°C	33A
Max. Pulse Discharge Current @25°C	66A
DC Resistance	≤100mΩ

MECHANICAL SPECIFICATIONS

Dimensions (L x W x H)	196 x 132 x 154mm
BCI Group U1 & Ur1	7.7 x 5.2 x 6.2in
Weight	4.7kg / 10.3lbs
Terminal Type	M6
Chemistry	LiFePO ₄

PERFORMANCE SPECIFICATIONS

100% DoD Cycles @ 25°C, 1C/1C	≥2000
Voltage Limit	8.0V ~ 14.6V
Charge Temperature Range	0°C ~ 45°C
Discharge Temperature Range	-20°C ~ 55°C

BATTERY MGMT. SYSTEM SPECIFICATIONS

Short Circuit Protection	YES
Over Charge Protection	15.2V ± 200mV (≤1.5s)
Reconnect Voltage	14.4V ± 200mV
Over Discharge Protection	8V ± 320mV (≤150ms)
Reconnect Voltage	9.2V ± 400mV
Balancing Voltage	14.4V ± 100mV (53mA ± 10mA)
Over Temperature Protection	65°C ± 5°C (55°C ± 10°C release)
Over Current Protection	100A - 140A (≤25ms)

Note: maximum of 4 (packs) in series = 51.2v Nominal Charge
Also, maximum of 2 batteries in parallel.



Why Lithium-ion vs. SLA?

Increased Cycle Lives - 2,500+ full cycle lives versus 300 for an average SLA

Lighter and More Portable
- Up to 50% lighter than traditional SLA

High Efficiency Charging
- Much faster re-charge time vs. SLA

Extended Overall Battery Life Cycle
- Lasts 5X+ longer than an average SLA

Lower Overall Cost of Ownership
- Li-ion is actually less expensive over the lifetime of the battery vs. SLA

Safe w/ No Maintenance Required
- Sealed construction for safety, durability and requires no maintenance

12 YEAR WARRANTY!



#551114

33Ah 12.8V



LC BATTERY PERFORMANCE vs. SLA

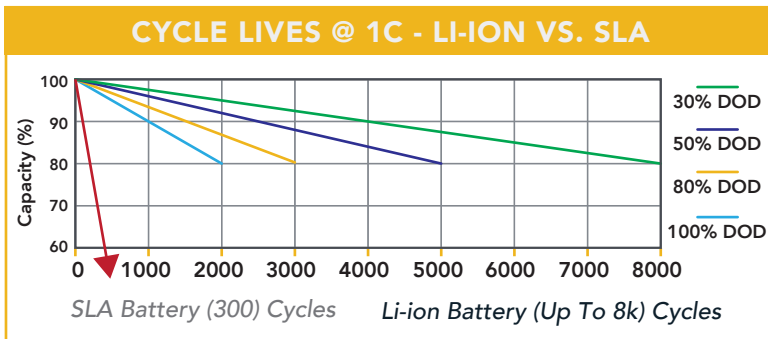

LI-ION VS. SLA INVESTMENT COMPARISON

LITHIUM ION

Li-ion provides maximum energy and consistent power much longer than SLA and at a lower overall cost (over the life of the battery)

\$ = 5-10 yr.

SEALED LEAD ACID

The average SLA battery requires replacement every 24 months (increasing overall costs)

\$\$+ = 5-10 yr.

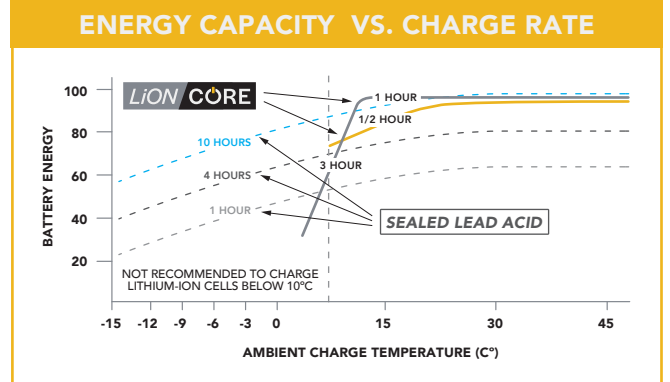
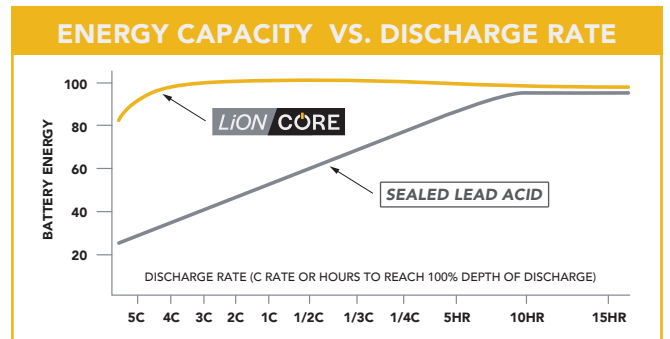

MECHANICAL DRAWINGS (mm)

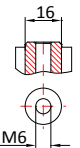
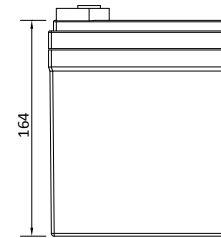
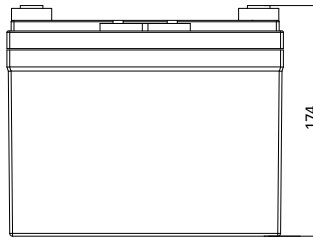
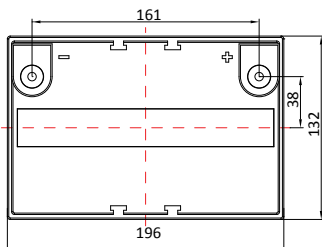

COMPLIANCE SPECIFICATIONS

Certifications	UN38.3, CE
Shipping Classifications	UN3480, Class 9
Product Number	551114

Note: maximum of 4 (packs) in series = 51.2v Nominal Charge
Also, maximum of 2 batteries in parallel.

LiONCore deep cycle batteries are not intended for cold-cranking use.



ELECTROVOLT
14028 N. OHIO STREET
RATHDRUM, ID 83858
877.440.3344

electroVOLT™
VERTICAL PARTNERS WEST LLC



ElectroVolt is a Vertical Partners West company. VPW has over 20 years experience in energy storage and is an ideal partner for your Commercial, OEM, and Industrial projects. As a U.S. based supplier VPW offers the highest quality products with manufacturing and testing facilities in Asia and at our headquarters located in Idaho, USA.

The information contained herein is provided solely for the purpose of general explanation and illustration and is subject to modification without notice. No warranty or guarantee is given in regard to the information contained herein or the referenced products. Please contact Vertical Partners West® for the most current and relevant product information for your application. © 2021 ElectroVolt. All Rights Reserved.